

# FOR LEASE

225 Dunn Road  
Fayetteville, NC 28312



## OVER 70K SF OF WAREHOUSE SPACE LOCATED ON DUNN ROAD

### Offering Summary

Lease Price: \$5-\$10/SF NNN  
Size: Over 70,000 SF  
Zoned: HI—Heavy Industrial

### Property Description

Over 70k sq feet Warehouse/Storage Space conveniently located to I-95, airport, downtown, Hwy 24/87. Multiple buildings, some climate controlled. Lease the entire complex, or just one building. \$5-10/sq ft depending on how much space is required, and which building(s). Price varies from building-to-building, and space-to-space. See additional pages of brochure for more details.



### **Deno Hondros**

910.802.0076 | DenoHondros@gmail.com

### **Thomas Lloyd**

910.574.3177

Tom@FranklinJohnsonCommercial.com

**FOR LEASE**

225 Dunn Road  
Fayetteville, NC 28312



**OVER 70K SF OF WAREHOUSE SPACE LOCATED ON DUNN ROAD**

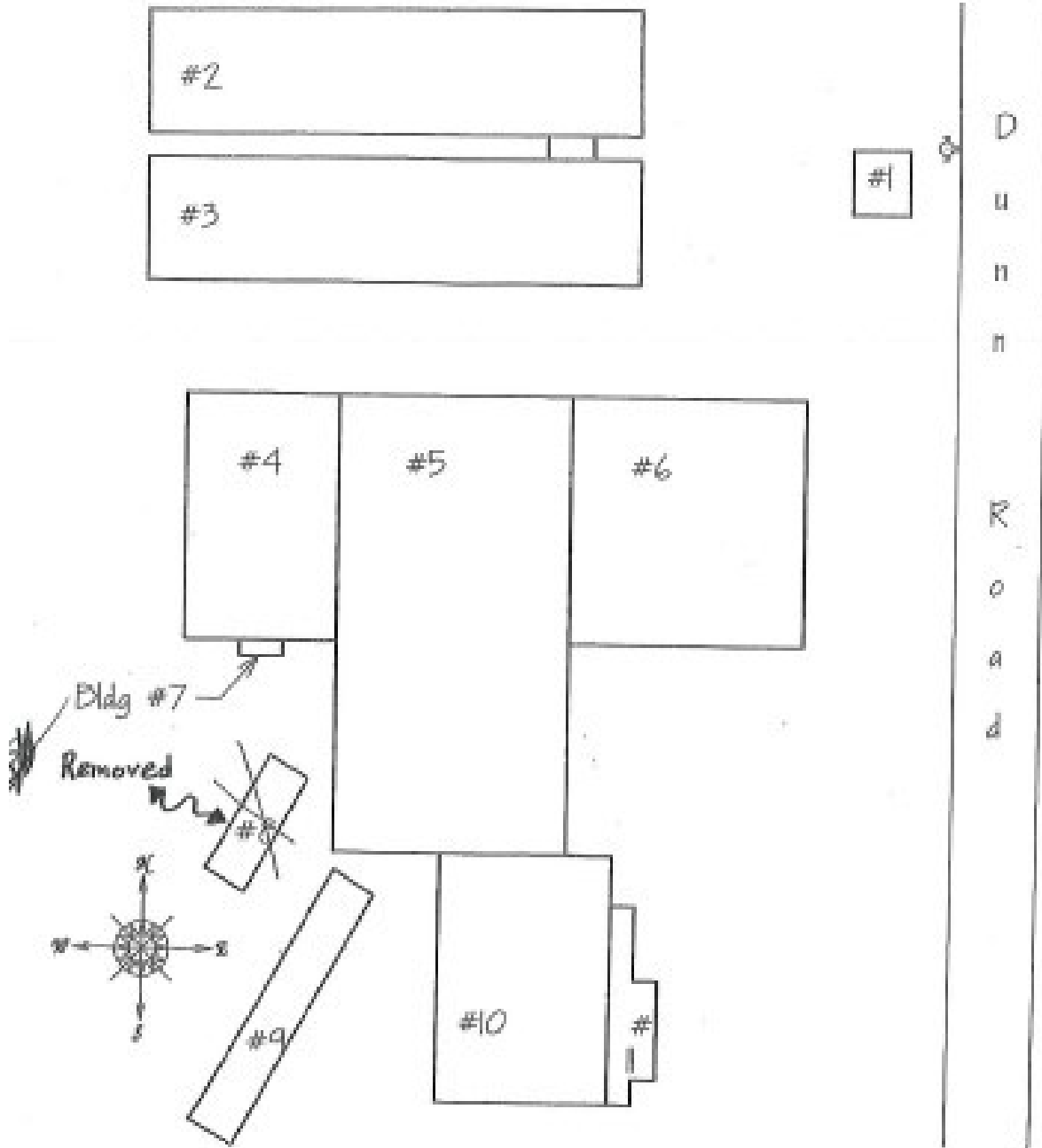

**Deno Hondros**  
910.802.0076 | DenoHondros@gmail.com  
**Thomas Lloyd**  
910.574.3177  
Tom@FranklinJohnsonCommercial.com

## FOR LEASE

225 Dunn Road  
Fayetteville, NC 28312



## OVER 70K SF OF WAREHOUSE SPACE LOCATED ON DUNN ROAD

Details of diagram for Riverside Mattress Company.

Building #1 - 1-Story, Joisted Masonry on a slab. 624 Square Feet. Used for Storage. Built in 1965.

Building #2 - 1-Story, Non-Combustible on a slab. 10,500 Square Feet. Used for Warehouse. Built in 1983.

Building #3 - 1-Story, Non-Combustible on a slab. 10,500 Square Feet. Used for Warehouse. Built in 1983.

Building #4 - 1-Story, Non-Combustible on a slab. 6,400 Square Feet. Used for Box Spring Assembly. Built in 1983. HVOC / 9' HIGH / 15' x 10' DOCK HIGH DRIVE

Building #5 - 1-Story, Non-Combustible on a slab. 18,500 Square Feet. Used for mattress assembly. Built in 1991. HVOC / 13' HIGH / 17' x 9' / Sprinkled Drive In

Building #6 - 1-Story, Non-Combustible on a slab. 9,500 Square Feet. Used for Warehouse. Built in 1983. Insulated

Building #7 - 1-Story, Non-Combustible on a slab. 126 Square Feet. Used for Air Compressor storage. Built in 1993.

Building #8 - 1-Story Frame on a slab. 1,007 Square Feet. Used for storage. Built in 1965.

Building #9 - 1-Story, Joisted Masonry on a slab. 2,360 Square Feet. Used for Assembly. Built in 1965.

Building #10 - 1-Story, Joisted Masonry on a slab. 7,400 Square Feet. Used for Assembly operations. Built in 1965.

Building #11 - 1-Story, Joisted Masonry on a slab. 1,200 Square Feet. Used for Office space. Built in 1965.

NOTE: All Building are non-sprinklered.

**Deno Hondros**

910.802.0076 | DenoHondros@gmail.com

**Thomas Lloyd**

910.574.3177

Tom@FranklinJohnsonCommercial.com